

### PCP & LSOH Shroud

- Polychloroprene is a family of synthetic rubbers that are produced by polymerization of chloroprene. Polychloroprene (PCP) was one of the first commercially available synthetic rubbers and is an exceptionally tough and flexible sheathing material with resistance to tears, abrasions, impact, crushing and chipping.
- PCP has a broad temperature range and doesn't become brittle even at temperatures as  $-40^{\circ}\text{C}$  /  $+120^{\circ}\text{C}$ . It has very good resistance to swelling and to a wide range of chemicals including both natural oils and aliphatic hydrocarbons, making it particularly useful as a sheathing material for applications such as trailing cables and dredge cables used in mining industry and the oil & gas industries. It is also resistant to a range of solvents, acids and alkalis, mildew, fungus and many other biological agents, making it ideal for use in chemical plants. As a sheathing material it provides the cable with superior weathering resistance and has proven to have excellent ageing properties in permanent outdoor applications. PCP also has very good fire resistant properties.

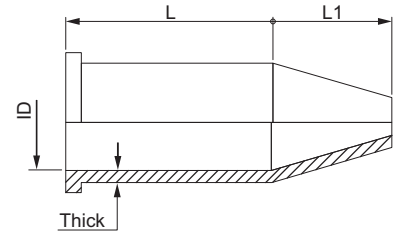

### SHROUD FOR A2F CABLE GLAND

| Size | PCP Code  | LSOH Code | ID     | L     | L1     | Thick |
|------|-----------|-----------|--------|-------|--------|-------|
| 20s  | CPCA2F20S | CSLA2F20S | 23.00  | 35.00 | 45.00  | 1.50  |
| 20   | CPCA2F20L | CSLA2F20L | 27.00  | 35.00 | 45.00  | 1.50  |
| 25s  | CPCA2F25S | CSLA2F25S | 38.00  | 40.00 | 55.00  | 1.50  |
| 25   | CPCA2F25L | CSLA2F25L | 38.00  | 40.00 | 55.00  | 1.50  |
| 32   | CPCA2F32L | CSLA2F32L | 43.00  | 50.00 | 55.00  | 1.50  |
| 40   | CPCA2F40L | CSLA2F40L | 53.00  | 55.00 | 55.00  | 1.50  |
| 50s  | CPCA2F50S | CSLA2F50S | 58.00  | 55.00 | 65.00  | 1.50  |
| 50   | CPCA2F50L | CSLA2F50L | 64.00  | 60.00 | 70.00  | 1.50  |
| 63s  | CPCA2F63S | CSLA2F63S | 74.00  | 60.00 | 70.00  | 1.50  |
| 63   | CPCA2F63L | CSLA2F63L | 79.00  | 70.00 | 70.00  | 1.50  |
| 75s  | CPCA2F75S | CSLA2F75S | 88.00  | 75.00 | 70.00  | 1.50  |
| 75   | CPCA2F75L | CSLA2F75L | 95.00  | 75.00 | 80.00  | 1.50  |
| 90   | CPCA2F90L | CSLA2F90L | 113.00 | 85.00 | 110.00 | 1.50  |

### SHROUD FOR E1FW CABLE GLAND

|     |            |            |        |        |        |      |
|-----|------------|------------|--------|--------|--------|------|
| 20s | CPCE1FW20S | CSLE1FW20S | 25.00  | 60.00  | 30.00  | 1.50 |
| 20  | CPCE1FW20L | CSLE1FW20L | 32.00  | 65.00  | 30.00  | 1.50 |
| 25s | CPCE1FW25S | CSLE1FW25S | 38.00  | 72.00  | 35.00  | 1.50 |
| 25  | CPCE1FW25L | CSLE1FW25L | 38.00  | 72.00  | 35.00  | 1.50 |
| 32  | CPCE1FW32L | CSLE1FW32L | 48.00  | 76.00  | 40.00  | 1.50 |
| 40  | CPCE1FW40L | CSLE1FW40L | 58.00  | 75.00  | 85.00  | 1.50 |
| 50s | CPCE1FW50S | CSLE1FW50S | 63.00  | 85.00  | 85.00  | 1.50 |
| 50  | CPCE1FW50L | CSLE1FW50L | 71.00  | 85.00  | 85.00  | 1.50 |
| 63s | CPCE1FW63S | CSLE1FW63S | 82.00  | 100.00 | 90.00  | 1.50 |
| 63  | CPCE1FW63L | CSLE1FW63L | 82.00  | 100.00 | 90.00  | 1.50 |
| 75s | CPCE1FW75S | CSLE1FW75S | 95.00  | 110.00 | 110.00 | 1.50 |
| 75  | CPCE1FW75L | CSLE1FW75L | 106.00 | 110.00 | 120.00 | 1.50 |
| 90  | CPCE1FW90L | CSLE1FW90L | 118.00 | 110.00 | 120.00 | 1.50 |

### LSOH MATERIAL PROPERTIES

|                      |                          |
|----------------------|--------------------------|
| Grade                | Halogen Free             |
| Colour               | Black Red Orange & White |
| Hardness ( IRHD)     | 65 m- 70 Shore A         |
| Modulus Mpa          | No Data Available        |
| Tensile Strength Mpa | 7 Min                    |
| Tear Strength        | 23 n/m                   |
| Elongation @ Break % | 400 Min                  |
| High Temp use (Con)  | +250°C                   |
| High Temp use (Peak) | +275°C                   |
| Low Temp Flexibility | -60°C                    |
| Oxygen Index         | 32.00                    |
| UL Rating            | Not Tested               |
| Smoke Evolution      | Low Smoke Ao<0.029       |
| Food Quality         | No                       |
| Medical              | No                       |
| Oil Resistant        | Fair                     |
| Dielectric Strength  | High                     |
| Ozone Resistance     | Excellent                |
| Halogen Content      | <0.5                     |

### PCP MATERIAL PROPERTIES

|                     |           |
|---------------------|-----------|
| Temp. Range, °C     | -0.35     |
| Compression Set     | Fair/Good |
| Strength Properties | Good      |
| Low Temp. Prop.     | Good      |
| Abrasion Resist.    | Good      |
| Gas Permeability    | Good      |
| Weather Resist.     | Good      |
| Water Resistance    | Fair      |
| Ozone Resistance    | Good      |
| Mineral Oil Resist. | Good      |
| Chemical Resist.    | Fair      |
| Flame Resistance    | Excellent |
| Heat Resistance     | Good      |